

STAGEMAKER

Hook suspended - Industrial position

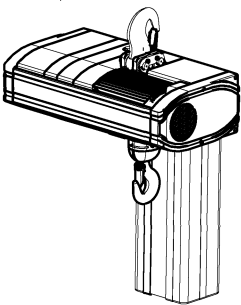
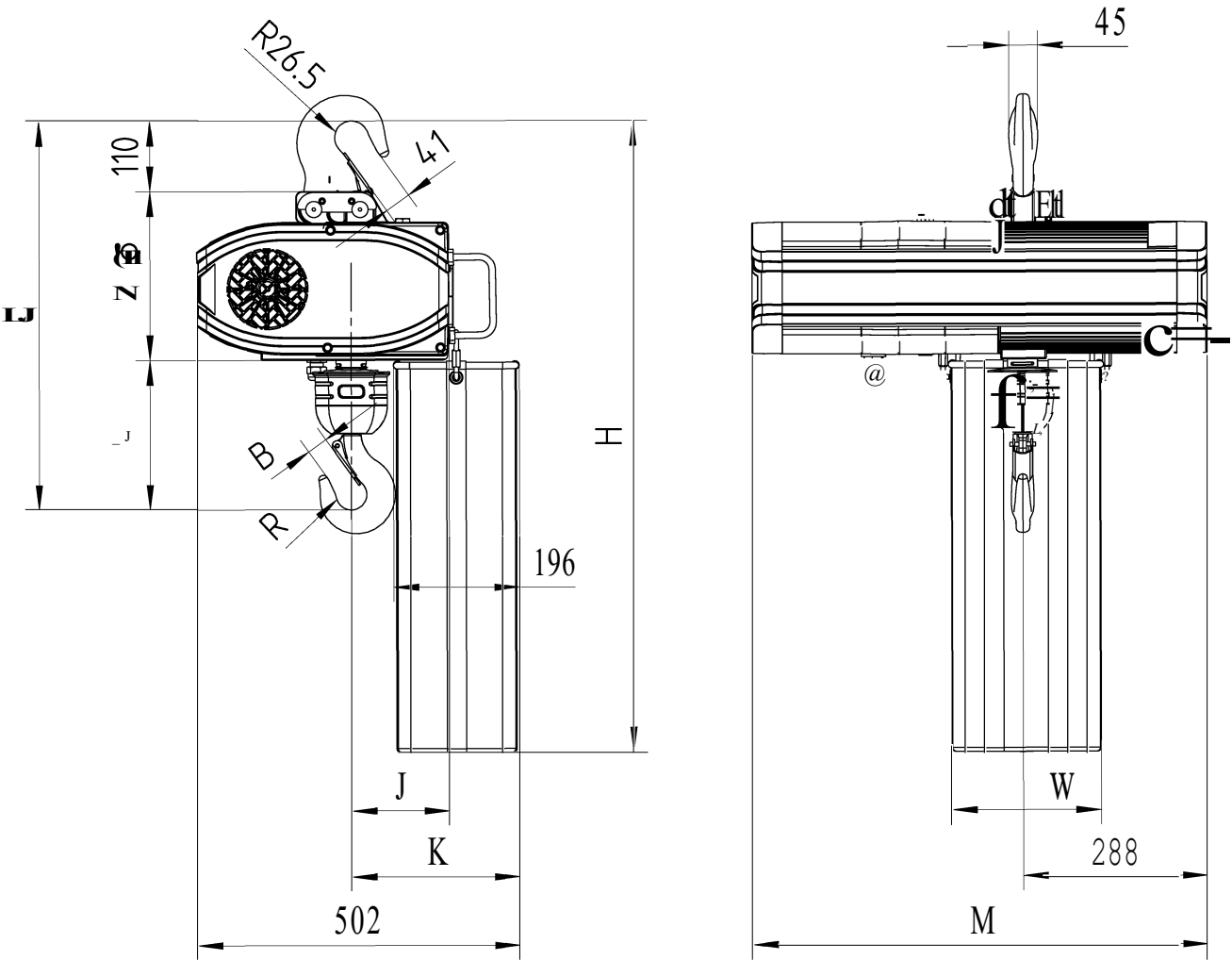

[hrnn Size (mm)	Max load (kg)	Falls	Chain bag capacity (ml)	Dimensions (mm)										Weight of chnrn (kg/m)	Estimated weight of hoist w/o chain (Kg)		
				B	[	L	R	J	K	H	W	M			SB	GLS	DB
												SB/GLS	DB				
113X31	2500	1	20	33	611	238	24	159	262	990	232	587	709	2.85	120	125	126
			SO							1360	410						
	5000	2	20 (*)	41	761	388	28	208	311	990	232				125	130	131
			SO (*)							1360	410						

SB: Unique Frein / Single Brake / Einzel Bremse  
DB: Double Frein / Double Brake / Zusdtzliche Bremse  
(\*) In case of 2-fall hoist, available lifting height of the chain bag maximum capacity